

SQUARE CAPS — PRESSED STEEL PAINTED BLACK

Item#	Size	Qty. Per Sack	PRICE EACH	
			Less Sack	Sack
83209	1"	100		
83217	1 1/2"	100		
83213	2"	100		
83218	2 1/2"	100		
83208	3"	100		
83207	3 1/2"	NA		
83219	4"	100		
83214	6"	NA		
83212	8"	NA		

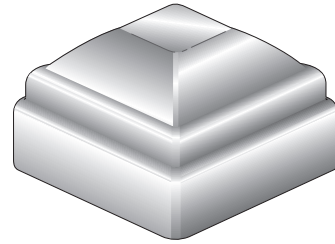

Designed to fit over outside edges of square post or gate frame.

PLASTIC INSERT PLUGS — SQUARE / RECTANGULAR

Item#	Size	PRICE EACH		
		1-199	200-499	500-up
83332	1/2" x 1/2" *			
83333	5/8" x 5/8" *			
83334	3/4" x 3/4"			
83335	1" x 1"			
83336	1 1/4" x 1 1/4"			
83337	1 1/2" x 1 1/2"			
83338	2" x 2"			
83347	3/4" x 1 1/2"			
83348	1" x 1 1/2"			
83349	1" x 2"			

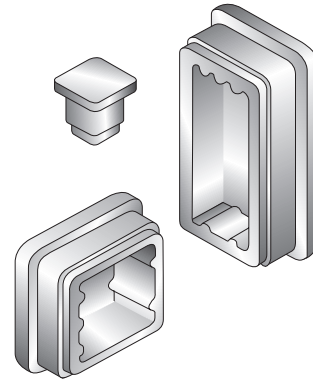

* 1/2" and 5/8" caps made to fit 18 GA. tubing, all others made to fit 16 GA. tubing. Call for availability & pricing of other gauges.

WELDABLE IRON POST CAP WITH BALL

Item#	Post Size	Style	PRICE EACH	
			1-199	200-up
83193	1"	Flat Base		
83194	1 1/2"	Flat Base		
83194-10	1 1/2"	Cup Base		
83195	2"	Cup Base		
83197	2 1/2"	Cup Base		
83196	3"	Cup Base		
83198	4"	Cup Base		



Ball Cap

COMPLETE SPRAYER SYSTEM KIT FOR ONE COAT SYSTEM

BFC TOUCH-UP PAINT FOR STANDARD COLORS

BFC Standard Polyurethane Colors or

BFC Standard Polyester Powder Coat Colors

See *BFC Website or Brochures for LISTINGS of Standard Colors*

SPRAYER SYSTEM KIT FOR ONE & TWO COAT SYSTEM



83281 SP-1 KIT 4 oz.
 Kit includes: One power pack sprays up to 16 oz. of thinned paint.
 One glass jar with lid, will hold 5.5 oz. of thinned paint. **(No paint included)**

83282 SP-2 KIT 4.8 oz.
 Kit includes: One power pack sprays up to 16 oz. of thinned paint. **(No paint included)**
 Two glass jars with lids, each will hold 5.5 oz. of thinned paint.
 One power pack can be used to spray both the primer and the top coat.

POWER PACK ONLY

83283 Power Pack with Tube 3.2 oz.

JAR ONLY

83284 Glass Jar with Lid 0.8 oz.

The **SPRAYER SYSTEM** is a completely portable spray gun that gives professional results with almost any liquid. Simply read the directions and cautions on the product to be sprayed and follow the suggestions included with the sprayer.

AEROSOL SPRAY PAINT

Item#	Color	Size oz/can	PRICE EACH	
			Less Case	Case
83249	Silver	12		
83233	Gloss White	12		
83235	Semi-Gloss Black	12		
83236	Gloss Black	12		
83266	Grey Primer	12		
83285	Rustoleum Red Oxide Primer	20		
83286	Rustoleum 2185 Cold Galv.	20		

BFC TOUCH-UP AIR DRY ACRYLIC ENAMEL

84610-BK05	Black BKO5	12
84610-GN13	Dark Green GN13	12
84610-BR21	Terra Brown BR21	12



WELDABLE IRON CASTINGS

Item#	Size	Style#	PRICE EACH	
			1 - 199	200 - up
3740	1/2"	#251		
83741	5/8"	#251		
83742	3/4"	#251		
83750	1/2"	#217 w/ball		
83755	5/8"	#217 w/ball		
83756	3/4"	#217 w/ball		
83760	1/2"	#217		
83765	5/8"	#217		
83768	3/4"	#217		
83770	1/2"	#215		
83775	5/8"	#215		
83798	3/4"	#215		
83780	1/2"	#218		
83785	5/8"	#218		
83785-10	3/4"	#218		
83786	1/2"	#227		
83787	5/8"	#227		
83790	3/4"	#227		
84077	1/2"	#260		
84078	5/8"	#260		
84079	3/4"	#260		
84041-500	1/2"	#270		
84041-625	5/8"	#270		
84041-750	3/4"	#270		
84066-05	3/4"	#9-Y		
84045	3/4"	#671AF		
84045-10	1"	#671XL		



Style #251



Style #217

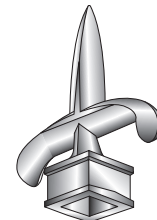

Style #218



Style #260



Style #9-Y

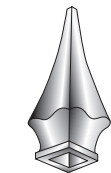

Style #671AF



Style #217 w/Ball



Style #215

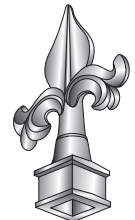

Style #227



Style #270

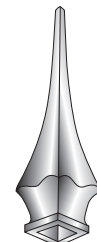

Style #671XL

- Specify picket size when ordering.
- Refer to SPECIAL PRICING APPLICATIONS section page 6 for welded on prices.

8530 UNSWORTH AVE. SACRAMENTO, CA 95828-1009 1-916-381-4065	13111 DAHLIA ST. FONTANA, CA 92337-6902 1-909-350-9040	8937 SAN FERNANDO RD. SUN VALLEY, CA 91352-1410 1-818-504-3700	1265 N. CUYAMACA ST. EL CAJON, CA 92020-1549 1-619-449-0333	10010 PORTLAND AVE. TACOMA, WA 98445-3956 1-253-535-5500
---	--	--	---	--

SQUARE POST FLANGES

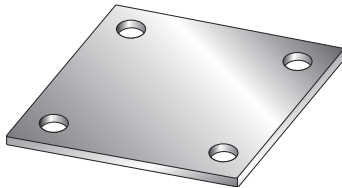

Item#	Size x Thickness	Qty. Per Sack	PRICE EACH	
			Less Sack	Sack

UNPAINTED
83331 4" x 4" x 1/8" 100

GALVANIZED
16830 6" x 6" x 1/4" 25

GALVANIZED
16831 8" x 8" x 1/4" 25

- 6" & 8" have 5/8" holes
- 4" has 3/8" holes
- Weld on application

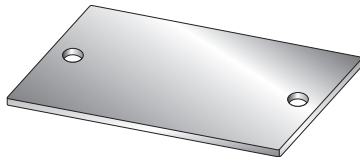

RECTANGULAR POST FLANGE

UNPAINTED
83319 2" x 4" x 1/4" 100

- 1/2" bolt holes
- Weld on application

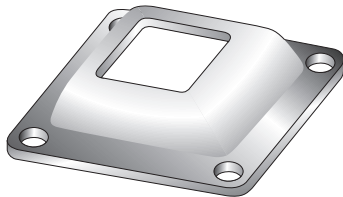

DECORATIVE SQUARE FLANGES

Item#	Post Size	Qty. Per Sack	PRICE EACH	
			Less Sack	Sack

83220 1" 50

83223 1 1/4" 50

83221 1 1/2" 50

83222 2" 50

- 3/8" bolt holes
- Weld on application
- Refer to post size when ordering



90 DEGREE STEEL PIPE ELBOWS

Item#	O.D.	Style	PRICE
-------	------	-------	-------

16784 1 7/8" Plain

16784-05 1 7/8" Galvanized

16786 1 5/8" Plain

16786-05 1 5/8" Galvanized

- All 2" inside radius

HANDRAIL BRACKET

Item#	PRICE		
	1 - 199	200 - 499	500 - up

83179

- 25/64" bolt hole
- Weld to handrail
- Bolt to wall

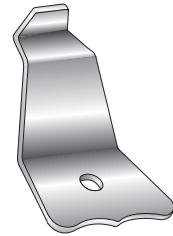

WAGNER HANDRAIL BRACKET

83178

- 7/16" bolt hole
- Weld or Bolt to handrail
- Bolt to wall



1" x 1 3/4" x 3/16" MOUNTING TABS

83327

- 1/2" bolt hole
- Weld on application

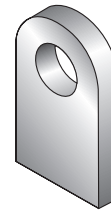

DECORATIVE MOUNTING TABS

83200

- 3/8" bolt hole
- Weld on application



WELDABLE IRON "RAIL" CASTINGS (MATCHES CAP RAIL IN POST SECTION)

Item#	Number	Style	PRICE EACH
84000	#20	Monkey Fist	
84001	#19 S	Lamb's Tongue	

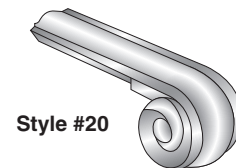
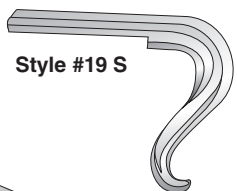

For cement & grout see the Accessories section in the Chain Link Catalog (yellow tab), page 5.

8530 UNSWORTH AVE. SACRAMENTO, CA 95828-1009 1-916-381-4065	13111 DAHLIA ST. FONTANA, CA 92337-6902 1-909-350-9040	8937 SAN FERNANDO RD. SUN VALLEY, CA 91352-1410 1-818-504-3700	1265 N. CUYAMACA ST. EL CAJON, CA 92020-1549 1-619-449-0333	10010 PORTLAND AVE. TACOMA, WA 98445-3956 1-253-535-5500
---	--	--	---	--



PANEL MOUNTING BRACKETS WITH SPRING LOADED PIN

Item#	Rail Size	Gauge	Qty. Per Sack	PRICE EACH	
				Less Sack	Sack
83182-SP	1" sq.	16/14	100		
83181-SP	1 1/2" sq.	16/14	100		

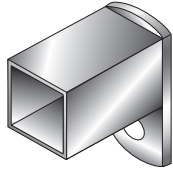

WALL MOUNTING BRACKET

83182	1" sq.	16	100
83182-10	1" sq. Biasable	16	100
83181	1 1/2" sq.	14	100
83182-20	2" sq.	14	50
83182-25	2" sq.	11	50

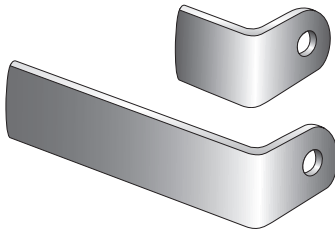

WELD ON MOUNTING BRACKETS

83184-106	1 1/2" x 1 1/2" x 1 1/2" wide	100
83184-107	4" x 1 3/4" x 1 1/2" wide	100

- Both in 8 Gauge with 3/8" hole

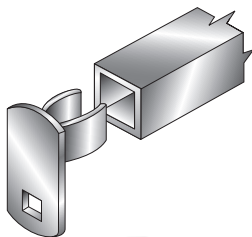

PANEL MOUNTING BRACKET — CLIP STYLE

83183	1" sq.	100
-------	--------	-----

- Allows for a bolt on installation to wall or post.
- For use on panels with 1" sq. rails.



BLACK DRILL POINT TEK SCREWS

Item#	Size	Sold in	
		Bags of 100	PRICE EACH
13711	1/4" - #14 x 1" Hex Zinc Coated Head	100	



BLACK USS FLAT WASHERS

13712	1/4" Zinc Coated	100
-------	------------------	-----

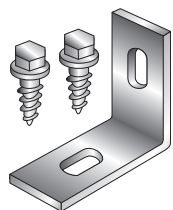

ANGLE MOUNTING CLIPS — WITH SCREWS

Kit#	Item#	Qty. Per Sack	PRICE EACH	
			Less Sack	Sack
V-1	91170	100		

CARRIAGE BOLTS, BLACK COATED — With Nuts

Item#	Size	Weight/Box	Qty. Per Box	PRICE EACH	
				Less Box	Box
10501-B	5/16" x 1 1/4"	2.66 lbs.	100		
10512-B	3/8" x 2 1/4"	5.31 lbs.	100		
10508-B	3/8" x 3"	6.66 lbs.	100		
10509-B	3/8" x 3 1/2"	7.55 lbs.	100		

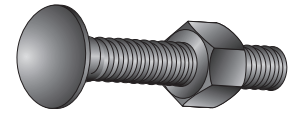

Black Coated

SLEEVE ANCHORS

Item#	Hole Size	Length	Qty. Per Box	PRICE EACH	
				Less Box	Box
25351	5/16"	1 1/2"	100		
25352	3/8"	1 7/8"	50		
25353	3/8"	3"	50		
25349	1/2"	2 1/4"	25		
25350	1/2"	3"	25		
25348	1/2"	4"	25		

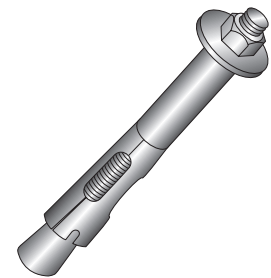

- No special tools needed
- Insert anchor
- Tighten with wrench

LAG SHIELDS

Item#	Shield Size x Length	Hole Size	Qty. Per Box	PRICE EACH	
				Less Box	Box
25320	1/4" x 1"	1/2"	50		
25322	3/8" x 1 3/4"	5/8"	50		
25327	5/16" x 1 3/4"	1/2"	50		
25328	3/8" x 2 1/2"	5/8"	50		

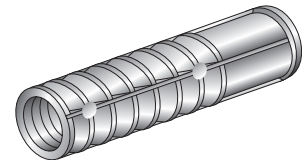

ONE-WAY SCREWS

Item#	Size	PRICE EACH
83499	4"	



ONE-WAY TOOL WITH 1/2" SQ. ADAPTER

Item#	PRICE EACH	
	1 -10	11- up
62163		
62164		

One way tool



Adapter

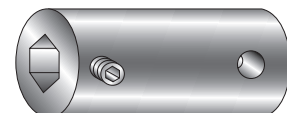

- One-way tool is designed for use with either electric drill or an impact wrench.
- Adapter converts one way tool for use with 1/2" sq. ratchet.
- This tool is used whenever one way screws are installed.

#1 Top Scroll



#2 Top Scroll

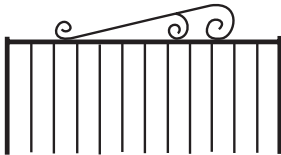

Fiesta Scroll

4" wide
12" long



Napoleon Scroll

5" wide
16" long



C-Scroll

2 1/2" wide
9 1/2" long



SCROLLS

Item#	Pattern Style	PRICE	
		Pattern Loose	Pattern Welded-in
83627	#1 Top Scroll 28"		
83628	#1 Top Scroll 48"		
83629	#1 Top Scroll 72"		
83630	#2 Top Scroll 36"		
83600	Fiesta Scroll 12"		
83602	Napoleon 16"		
83607	C- Scroll 9 1/2"		

- Top scrolls use 3/16" x 1" material.
- Fiesta, Napoleon and C-Scrolls use 3/16" x 1/2" material.

EMPIRE HOOPS / CIRCLES-WELDABLE

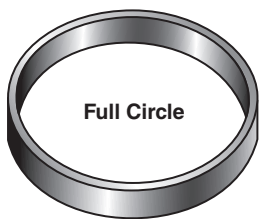

Full Circle



Empire Hoop
3/16" thick

Item#	Style	Picket Size	Qty. Per Sack	PRICE EACH	
				Less Sack	Sack
83226	Empire Hoop	1/2"	250		
83227	Empire Hoop	5/8"	250		
83228	Empire Hoop	3/4"	250		
83229	Full Circle	1/2"	250		
83230	Full Circle	5/8"	250		
83231	Full Circle	3/4"	250		
83232	Full Circle	1"	250		

Charlemagne #1



Charlemagne #2

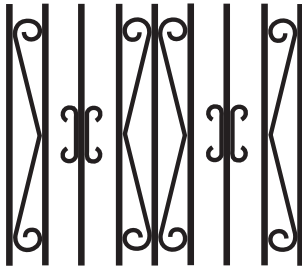

Charlemagne #3



Charlemagne #4

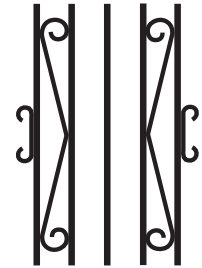

Charlemagne #5



Charlemagne #6



Charlemagne #7



Charlemagne #8



Charlemagne #9



- Loose patterns include the scrolls necessary to install pattern as shown.
- Welded-in prices shown are in addition to nonstandard fence or gate prices.
— Specify pattern when ordering —

SCROLLS PRICES PER PATTERN

Item#	Pattern Style	Pattern Loose	Pattern Welded-in
83615	Charlemagne #1		
83616	Charlemagne #2		
83617	Charlemagne #3		
83618	Charlemagne #4		
83619	Charlemagne #5		
83620	Charlemagne #6		
83621	Charlemagne #7		
83622	Charlemagne #8		
83623	Charlemagne #9		
83624	Fiesta #1		
83625	Fiesta #2		
83626	Fiesta #3		

Fiesta #1

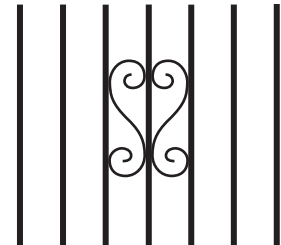

Fiesta #2

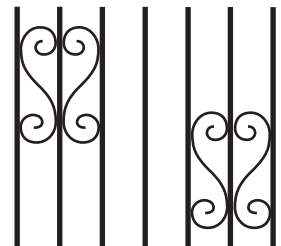

Fiesta #3

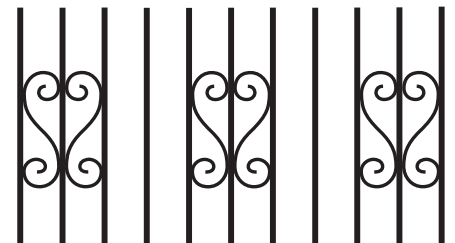

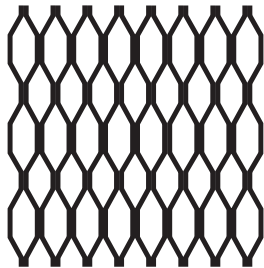

- #16 thickness
- 1/2" diamond
- Flattened

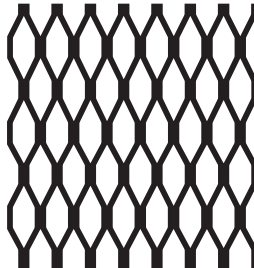

- #13 thickness
- 1/2" diamond
- Flattened

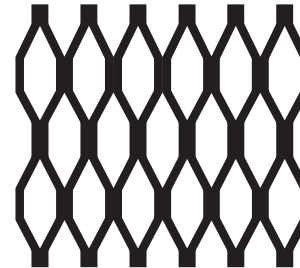

- #9 thickness
- 3/4" diamond
- Flattened

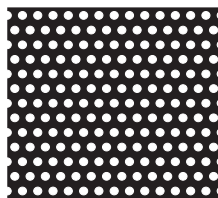

- Small hole — 1/16"
- 1/8" staggered centers
- 24 gauge thickness

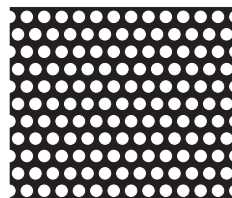

- Large hole — 3/32"
- 3/16" staggered centers
- 24 gauge thickness

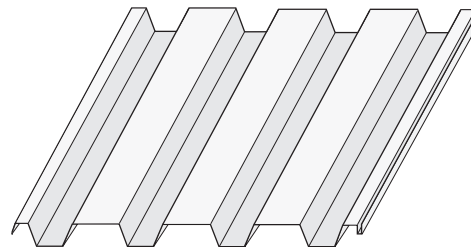

- Galvanized decking

EXPANDED METAL — 48" x 96" SHEETS

Item#	Gauge x Diamond	Wt (lbs.)	Sheet Size	PRICE EACH	
				1 - 9	10 - up
85000	#16 x 1/2"	27.50	48" x 96"		
85001	#13 x 1/2"	47.00	48" x 96"		
85002	#9 x 3/4"	57.60	48" x 96"		

PERFORATED METAL

Item#	Style	Weight (lbs.)	Sheet Size	PRICE EACH	
				1 - 9	10 - up
85003	Small Hole	18.80	36" x 84"		
85004	Small Hole	25.00	48" x 84"		
85005	Large Hole	16.10	36" x 84"		
85006	Large Hole	21.80	48" x 84"		

GALVANIZED DECKING — 20 GAUGE

16832-072	Box Rib Decking	36.00	3' x 6'
16832-096	Box Rib Decking	48.00	3' x 8'