

Post Size Tie Length	Item#	Bag Qty.	Case Qty.	Weight Each	PRICE EACH	
					Bag	Case

FENCE TIES (STEEL) – 12 GA. CUT & HOOKED – ZINC COATED

1 3/8" - 5 1/2"	15201	100	2,000	.02 lbs.
1 5/8" - 6 1/2"	15206	100	2,000	.02 lbs.
1 7/8" - 7 1/2"	15202	100	2,000	.02 lbs.
2 3/8" - 8 1/2"	15203	100	2,000	.02 lbs.
Barb Arms 12"	15221	100	2,000	.03 lbs.

FENCE TIES (STEEL) – 11 GA. CUT & HOOKED – ZINC COATED*

1 5/8" - 6 1/2"	15210	100	2,000	.03 lbs.
1 7/8" - 7 1/2"	15212	100	2,000	.03 lbs.
2 3/8" - 8 1/2"	15214	100	2,000	.03 lbs.
2 7/8" - 9 1/2"	15215	100	2,000	.02 lbs.

FENCE TIES (STEEL) – 9 GA. CUT & HOOKED – ZINC COATED*

1 5/8" - 6 1/2"	15240	100	1,000	.04 lbs.
1 7/8" - 7 1/2"	15241	100	1,000	.04 lbs.
2 3/8" - 8 1/2"	15242	100	1,000	.05 lbs.
2 7/8" - 9 1/2"	15252	100	1,000	.05 lbs.

ALUMINUM – 9 GA. CUT & HOOKED

1 7/8" - 6 1/2"	15263	100	3,700	.01 lbs.
2 3/8" - 8 1/4"	15264	100	3,100	.02 lbs.
2 7/8" - 9 1/4"	15268	100	2,600	.02 lbs.
10 1/2"	15272	100	1,000	.02 lbs.

ALUMINUM – 6 GA. CUT & HOOKED

1 5/8" - 6 1/4"	15265	100	2,300	.02 lbs.
2 3/8" - 8 1/4"	15266	100	1,800	.03 lbs.

STRAIGHT STEEL TIES – ZINC COATED

12 GA. - 7"	15281		2,850	.02 lbs.
-------------	-------	--	-------	----------

per lb.

*1.2 oz. zinc coating available – special order
– Call for pricing –

Size	Item#	Box Qty.	Box Weight	PRICE / LB.	
				Pound	Box

HOG RINGS – STEEL – ZINC COATED

12 1/2 GA.	15301	5,600	25 lbs.
9 GA. BOE	15290	2,700	25 lbs.
10 GA. #1	15302	3,300	25 lbs.
9 GA.	15303	2,100	25 lbs.
9 GA. Class III	15303-10	2,100	25 lbs.

HOG RINGS - ALUMINUM

9 GA.	15300	6,600	25 lbs.
-------	-------	-------	---------

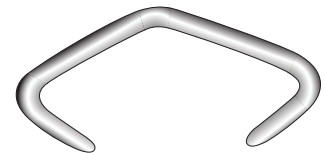
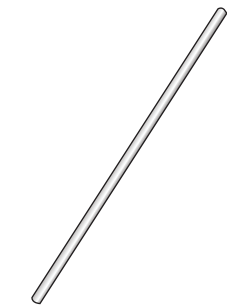
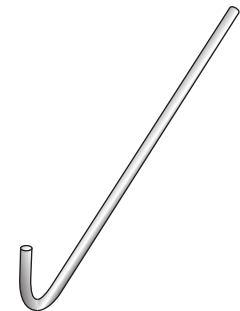
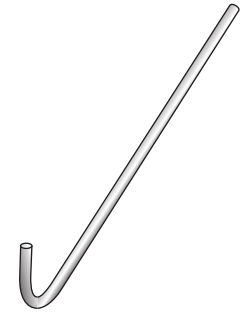

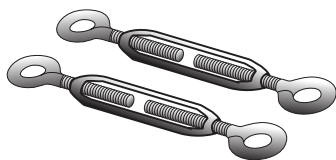
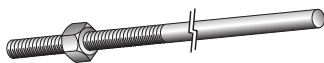
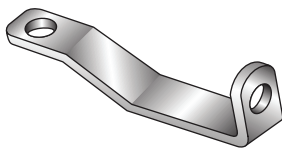
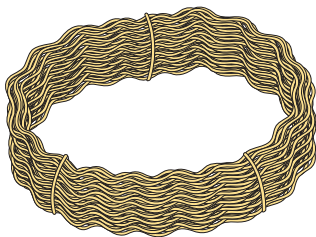
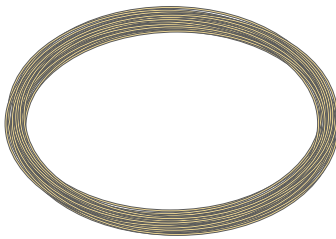

Size	Item#	Roll Weight	Feet Per Roll	PRICE Per Pound
------	-------	-------------	---------------	-----------------

GALVANIZED TENSION WIRE

6 GA.	15401	100 lbs.	1,017	
7 GA.	15402	100 lbs.	1,197	
9 GA.	15403	100 lbs.	1,705	
9 GA.	15403	50 lbs.	850	
10 GA.	15404	100 lbs.	2,057	
11 GA.	15405	100 lbs.	2,582	
12 GA.	15406	100 lbs.	3,369	
14 GA.	15407	100 lbs.	5,858	
18 GA.	15408	100 lbs.	16,620	

Sold in full rolls only

7 GAUGE GALVANIZED COIL SPRING

Commercial	15421	100 lbs.	1,197	
------------	-------	----------	-------	--

15422 & 15423 meet ASTM A824 Type II and Galvanized per ASTM A817, Type II, Classes 3 & 4

Class 3 — 0.9 oz.	15422	100 lbs.	1,197	
Class 4 — 1.2 oz.	15423	100 lbs.	1,197	

Sold in full rolls only

Size	Item#	Sack Qty.	Weight Each	PRICE EACH Less Sack	Sack
------	-------	-----------	-------------	----------------------	------

TRUSS TIGHTENER

Heavy	15801	50	.70 lbs.		
Pressed Steel	15802	50	.24 lbs.		

TRUSS ROD — THREADED WITH NUT

5/16" x 10 1/2'	15701	25	2.90 lbs.		
5/16" x 12'	15702	25	3.30 lbs.		

Full 3/8" Truss Rod Import, 2 oz — Meets ASTM F 626

3/8" x 12'	15702-F626	25	4.73 lbs.		
------------	------------	----	-----------	--	--

5/16" Truss Rod, Domestic, 1.2 oz — Meets ASTM F 626

5/16" x 12'	15702-F626D	25	3.30 lbs.		
-------------	-------------	----	-----------	--	--

For 20 ft. rods, call for pricing.

TURNBUCKLE

Aluminum Body					
5/16" x 3 1/2"	15901	20	.30 lbs.		
Galvanized Iron Body					
3/8" x 6"	15902	20	.50 lbs.		

Item#	Size	Sack Qty.	Weight Each	PRICE EACH	
				Less Sack	Sack

EYE BOLT, HOOK BOLT, BARBED WIRE STRETCH BOLT

15603	3/8" x 6" eye	100	.25 lbs.		
15641	5/16" x 6" hook	100	.13 lbs.		
15642	3/8" x 6" hook	100	.20 lbs.		
15661	(5/16" x 5" Wire Stretching)	100	.11 lbs.		



Galvanized with nuts

Item#	Size x Length	Hole Size	Qty Per Box	PRICE EACH	
				Less Box	Box

LAG SHIELDS

25320	1/4" x 1"	1/2"	50		
25322	3/8" x 1 3/4"	5/8"	50		
25327	5/16" x 1 3/4"	1/2"	50		
25328	3/8" x 2 1/2"	5/8"	50		

Use in conjunction with lag bolts (lag bolts not included)

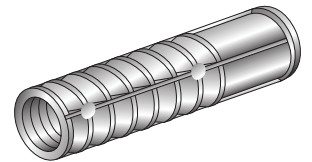

Item#	Hole Size	Length	Qty Per Box	PRICE EACH	
				Less Box	Box

SLEEVE ANCHORS

25351	5/16"	1 1/2"	100		
25352	3/8"	1 7/8"	50		
25353	3/8"	3"	50		
25349	1/2"	2 1/4"	25		
25350	1/2"	3"	25		
25348	1/2"	4"	25		
25370	5/8"	3"	25		

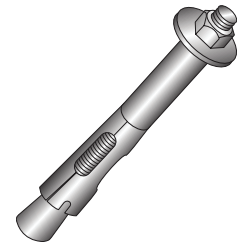

- No special tools needed
- Insert anchor
- Tighten with wrench

Item#	Size	Sack Qty.	Weight Each	PRICE EACH	
				Less Sack	Sack

ROUND FENCE POST FLANGE WITH FOUR 1/4" HOLES

16820	For 1 3/8" O.D.	25	.60 lbs.		
16821	For 1 5/8" O.D.	25	.64 lbs.		
16822	For 1 7/8" O.D.	25	.80 lbs.		
16823	For 2 3/8" O.D.	25	.96 lbs.		



FENCE POST FLANGE – FLAT PLATE, GALVANIZED, 5/8" HOLES, 1/4" THICK

16830	6" x 6"	25	2.56 lbs.		
16831	8" x 8"	25	4.56 lbs.		
16825	3" x 6"	25	1.28 lbs.		

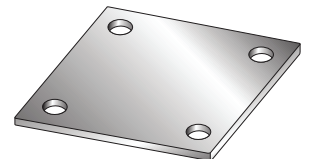

LAG BOLTS

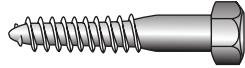

Size	Item#	Qty Per Box	Weight Each	PRICE EACH	
				Les Box	Box
1/4" x 1 1/2"	10478	100	.021 lbs.		
1/4" x 2"	10479	100	.027 lbs.		
1/4" x 2 1/2"	10480	100	.032 lbs.		
1/4" x 3"	10481	100	.038 lbs.		
5/16" x 1 1/2"	10482	100	.037 lbs.		
5/16" x 2"	10483	100	.046 lbs.		
5/16" x 2 1/2"	10484	100	.055 lbs.		
5/16" x 3"	10485	100	.064 lbs.		
3/8" x 1 1/2"	10486	100	.053 lbs.		
3/8" x 2"	10487	100	.066 lbs.		
3/8" x 2 1/2"	10488	50	.078 lbs.		
3/8" x 3"	10489	50	.091 lbs.		
3/8" x 4"	10490	50	.116 lbs.		
3/8" x 4 1/2"	10490-10	50	.129 lbs.		
3/8" x 5"	10490-20	50	.141 lbs.		
3/8" x 6"	10490-30	50	.166 lbs.		
1/2" x 1 1/2"	10491	50	.110 lbs.		
1/2" x 2"	10492	50	.133 lbs.		
1/2" x 2 1/2"	10493	50	.155 lbs.		
1/2" x 3"	10494	50	.178 lbs.		
1/2" x 4"	10495	50	.112 lbs.		
1/2" x 6"	10497	50	.157 lbs.		

GALVANIZED CHAIN — PROOF COIL, UNTESTED

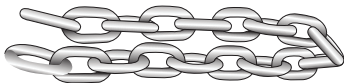

Size	Item#	Sack Qty.	Weight Each	PRICE EACH	
				Les Sack	Sack
3/16"	16001	250	100 lbs.		
1/4"	16002	150	100 lbs.		
5/16"	16003	100	100 lbs.		

GALVANIZED CABLE — 3/8", 7 STRAND, COMMON CABLE

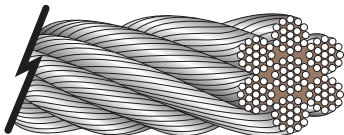

7 x 19

Size	Construction	Item#	Reel Quantity	PRICE / FOOT	
				Les Reel	Reel
3/8"	7 x 19	15430	500'		
3/8"	1 x 7	15429-10	500'		

Other quantities and diameters available on special order.

Meets specification RR-W-410E for wire rope.

AEROSOL SPRAY PAINT

Item#	Color	Size oz/can	PRICE EACH	
			Less Case	Case
83249	Silver	12		
83233	Gloss White	12		
83235	Semi-Gloss Black	12		
83236	Gloss Black	12		
83266	Grey Primer	12		
83285	Rustoleum Red Oxide Primer	20		
83286	Rustoleum 2185 Cold Galv.	20		



BFC TOUCH-UP AIR DRY ACRYLIC ENAMEL

84610-BK05	Black BK05	12
84610-GN13	Dark Green GN13	12
84610-BR21	Terra Brown BR21	12

Can be used on powder coated iron and chain link products

CEMENT — CONCRETE MIX

Item#	Size / Pallet Quantity	PRICE EACH	
		Less Pallet	Pallet
16126-94	Portland 94 lb. bag - 40 per pallet		
16130-90	Concrete Mix 90 lb. bag - 35 per pallet		
16130-60	Concrete Mix 60 lb. bag - 56 per pallet		
16158-94	Quikrete Portland 94 lb. bag - 35 per pallet		
16151-60	Red-E-Crete Concrete Mix 3500 PSI 60 lb. bag - 56 per pallet		
16151-90	Red-E-Crete Concrete Mix 3500 PSI 90 lb. bag - 35 per pallet		

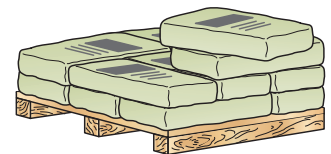

Add .50 per bag for delivery

QUICK SETTING GROUT 50 LB. PAIL — 36 PER PALLET

Item#	Brand	PRICE EACH	
		1 - 9	10 & up
16119	ReadySet		
16121	SuperSet		
16122	Quik-Rok		



16119



16121



16122

Quick setting grout, sets fence in 30 minutes.

Send your specifications to your BFC branch office.



Single Helical Coil



Standard Barb

REGULAR SECURITY (BTO) - SINGLE COIL
 BARBED TAPE OBSTACLE (BTO), STAINLESS STEEL
 WITH GALVANIZED CORE WIRE; 33 LOOPS PER ROLL

Size	Item#	Rolls Per Box	Roll Weight	Less Box Price Per Roll	Box Price Per Roll
18" Diameter SINGLE COIL	15525	5	11 lbs.		
24" Diameter SINGLE COIL	15527	5	17 lbs.		
<ul style="list-style-type: none"> • Coverage: 50' per roll with 18" attachment spacing. • Single coil is available in 30" diameters. 					

MEDIUM SECURITY (BTO) - MAZE (CONCERTINA)
 REINFORCING MATERIAL .098 DIAMETER, GALVANIZED WIRE,
 CL III FIN 2. 76 BARBS, 3 CLIPS PER LOOP; 31 LOOPS PER ROLL
 BARBED TAPE OBSTACLE (BTO), STAINLESS STEEL

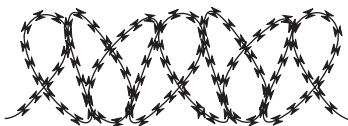

Maze (Concertina)

Size	Item#	Rolls Per Box	Roll Weight	Less Box Price Per Roll	Box Price Per Roll
18" Diameter	15548-S Galv.	4	11 lbs.		
<ul style="list-style-type: none"> • Coverage: 15' per roll with 12" attachment spacing, 3 clips, 31 loops 					
CONCERTINA CROSS TYPE WIRE (CB-65)					
24" Diameter					
CONCERTINA COIL	15543	5	17 lbs.		
<ul style="list-style-type: none"> • Coverage: 20' per roll with 16" attachment spacing. 3 clips, 31 loops. 					

HIGH SECURITY (BTO) - SUPERMAZE
 BARBED TAPE OBSTACLE (BTO), STAINLESS STEEL TAPE,
 12" SPACING, 5 CLIPS PER LOOP; 51 LOOPS PER ROLL

Size	Item#	Rolls Per Box	Roll Weight	Less Box Price Per Roll	Box Price Per Roll
30" Diameter Concertina Coil					
STAINLESS CORE WIRE	15545	3	32 lbs.		
GALVANIZED CORE WIRE	15545-SGALV	3	32 lbs.		
<ul style="list-style-type: none"> • Coverage: 25' per roll with 12" attachment spacing. 5 clips, 51 loops. • Double Coil (24" / 30") is available along with many other sizes & combinations. 					

8530 UNSWORTH AVE. SACRAMENTO, CA 95828-1009 1-916-381-4065	13111 DAHLIA ST. FONTANA, CA 92337-6902 1-909-350-9040	8937 SAN FERNANDO RD. SUN VALLEY, CA 91352-1410 1-818-504-3700	1265 N. CUYAMACA ST. EL CAJON, CA 92020-1549 1-619-449-0333	10010 PORTLAND AVE. TACOMA, WA 98445-3956 1-253-535-5500
---	--	--	---	--

BARBED WIRE — 5" x 12 1/2 GA

Style	Item#	Weight	Feet Per Roll	Price Per Roll
Domestic				
2 point - Class I	15497	78 lbs.	1,320	
4 point - Class I	15498	85 lbs.	1,320	
4 point - Class III	15500	85 lbs.	1,320	
Imported				
2 point	15521	78 lbs.	1,320	
4 point	15522	85 lbs.	1,320	

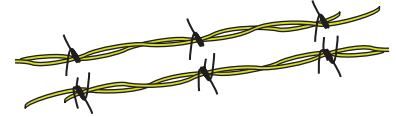

BARBLESS BARBED WIRE — 12 1/2 GA

Domestic

Barbless - Class I 15506 60 lbs. 1,320

Imported

Barbless 15524 60 lbs. 1,320

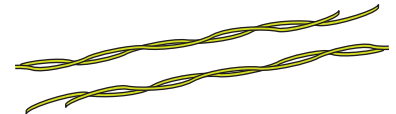

FENCE STAYS — 9 1/2 GA.

Style	Item #	Bundle Weight	Price 100 Each / Bundle
36"	15531	34 lbs.	
42"	15532	38 lbs.	
48"	15533	42 lbs.	

FENCE STAYS — 9 1/2 GA. Class 3 Zinc

36" 15531-10 34 lbs.
42" 15532-10 38 lbs.
48" 15533-10 42 lbs.

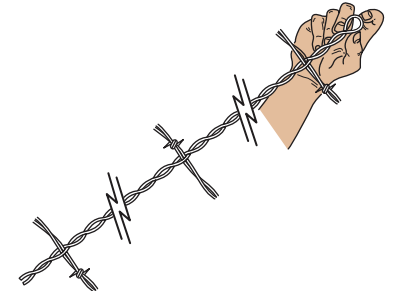

NIXALITE BIRD CONTROL

Style	Item#	Description	Per Foot Less Box	Box Price
Model S Nixalite	15558	4' strips only		

Mounting hardware included: 2 clips and washers per 4' piece with 2 drive screws for steel or iron. Other nails or screws may be required to mount on other surfaces.

Other models available: Contact your sales representative.

These stainless steel needle strips are long lasting, easy to install and virtually maintenance free. Used for small birds, swallows, pigeons, and seagulls. Excellent human intruder deterrent.

Material: 302 stainless steel **Other Lengths:** 24", 16", 12"
Base Strip: 1/4" wide, flexible by special order

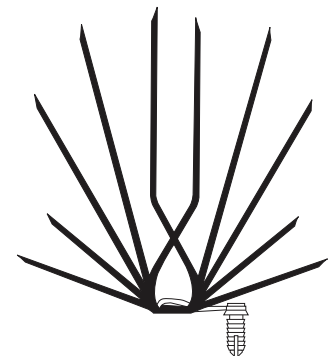

8530 UNSWORTH AVE. SACRAMENTO, CA 95828-1009 1-916-381-4065	13111 DAHLIA ST. FONTANA, CA 92337-6902 1-909-350-9040	8937 SAN FERNANDO RD. SUN VALLEY, CA 91352-1410 1-818-504-3700	1265 N. CUYAMACA ST. EL CAJON, CA 92020-1549 1-619-449-0333	10010 PORTLAND AVE. TACOMA, WA 98445-3956 1-253-535-5500
---	--	--	---	--

BottomLock

DECORATIVE VERTICAL CHAIN LINK SLAT
1 Bag = 10 feet

82 Slats Per Bag

LiteLink

ECONOMICAL VERTICAL CHAIN LINK SLAT
1 Bag = 10 feet

BottomLock & LiteLink both use bottom rail lock

7 STANDARD COLORS — PDS is available in:

Brown (10) Tan (50) Redwood (40) White (20) Green (30) Black (70) Gray (90) Sky Blue (60)

Sky Blue (60) & Royal Blue (602) — Available by special order only.

All 3½ foot heights are now the same price as 4 foot heights.

Item#	Fence Height	Wt (lbs) Per Bag	Price Per Bag
61180	3'	7	
61181	3½'	8	
61182	4'	9	
61183	5'	11	
61184	6'	13	
61185	7'	15	
61186	8'	17	
61187	10'	22	
61188	12'	26	

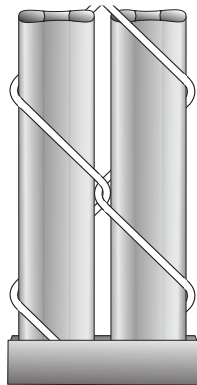

- Slat width 1-3/32" wide slat fits both
- 11 GA. and 9 GA.
- Manufacturer's 25-year limited warranty
- Slat is 3½" short of nominal length

Item#	Fence Height	Wt (lbs) Per Bag	Price Per Bag
61162	3'	4	
61163	3½'	5	
61164	4'	6	
61165	5'	7	
61166	6'	9	
61167	7'	10	
61168	8'	11	
61169	10'	14	
61170	12'	17	

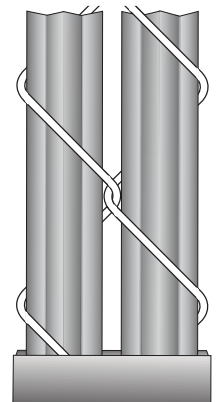

- One convenient size works for
- 9, 11, 11½ and 12 gauge wire
- Shipped in a compact 2" high by 6" wide box
- Slat is 3½" short of nominal length

FinLink

82 Slats Per Bag

Winged Slat

INCREASED PRIVACY FOR CHAIN LINK FENCE

2" Mesh x 11 gauge (only)

Item#	Fence Height	Wt (lbs) Per Bag	Price Per Bag
61101	3'	8	
61102	3½'	9	
61103	4'	10	
61104	5'	12	
61105	6'	14	
61106	7'	16	
61107	8'	18	

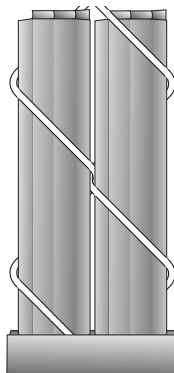

- Maximum height is 8'
- Bottom leveling channel
- Manufacturer's 25-year limited warranty
- Slat is 3½" short of nominal length

2" Mesh x 9 gauge (only)

Item#	Fence Height	Wt (lbs) Per Bag	Price Per Bag
60703	3'	8	
60702	3½'	9	
60704	4'	10	
60705	5'	12	
60706	6'	14	
60707	7'	16	
60708	8'	18	

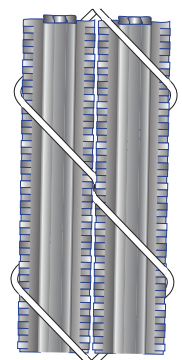

- For heights exceeding 8',
- 2 half sizes are recommended
- No locking systems needed
- Manufacturer's 25-year limited warranty
- Slat is 2" short of nominal length

PLASTICLINK SLATS — 2 3/8" WIDE

Item#	Fence Height	Wt (lbs) Per Bag	Price Per Each
60724	4'	32	
60725	5'	40	
60726	6'	47	
60727	7'	55	
60728	8'	62	
60730	10'	77	
60732	12'	90	

- Priced per bag
- 106 pieces per bag = 25 foot coverage
- Manufacturer's 25-year limited warranty
- Available in less bag quantities
- Call for pricing: Item #50348-

HEDGELINK

Item#	Fence Height	Wt (lbs) Per Box	Price Per Bag
61116	4'	18	
61117	5'	23	
61118	6'	27	
61119	7'	32	
61119-10	8'	36	
61119-120	10'	45	
61115	12'	54	

- One size fits both 2" and 2 1/4" mesh
- 10 lineal ft per box / 82 Hedge-Slats per box
- 16 ga. braided galv. wire / 3-mil PVC green
- DO NOT MIX Hedge-Link with any other Hedge product

SAFETY TOP CAP

Item#	Feet	Price Per Bag
61155-80	40 - 2,000' 2,000' +	

- Stocking Colors: Yellow only
- 40' per bag / 5 pieces at 8' each with 3 hole punched with 15 hog rings.
- 25 lbs. per bag.

• Available by special order only:		
Red (45)	White (20)	Green (30)
Dark Blue (602)	Brown (10)	Black (70)
• 6 week lead time.		
• Additional charge for special color		

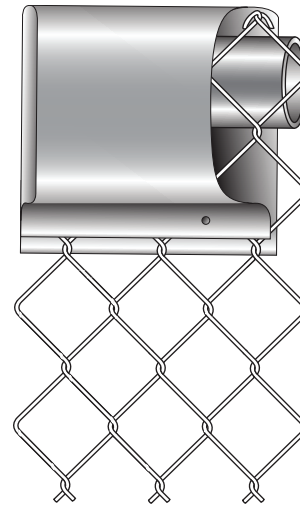

Safety Top Cap

CORRUGATED STEEL SHEET, 28 GAUGE

Item#	Size	Bundle Qty.	Weight Each	Less Bundle	Bundle
16839	6' x 26"	150	8.4 lbs.		
16840	8' x 26"	150	11.2 lbs.		
16841	10' x 26"	100	14.0 lbs.		
16842	12' x 26"	100	16.8 lbs.		

- 26 gauge available on special order

8530 UNSWORTH AVE. SACRAMENTO, CA 95828-1009 1-916-381-4065	13111 DAHLIA ST. FONTANA, CA 92337-6902 1-909-350-9040	8937 SAN FERNANDO RD. SUN VALLEY, CA 91352-1410 1-818-504-3700	1265 N. CUYAMACA ST. EL CAJON, CA 92020-1549 1-619-449-0333	10010 PORTLAND AVE. TACOMA, WA 98445-3956 1-253-535-5500
---	--	--	---	--

Mesh Designs



Approx. Mesh Size
ALPI - 3" x 1 1/2"

WOOD SNOW FENCE

Item#	Height	Description	Feet Per Roll	Weight Per Roll	Price Per Roll
50313-048	4'	Stained FLAT TOP	50	74 lbs.	

- Call for quantity discounts

ALPI 4' — SAFETY & SHOW FENCING

44501	4'	Orange - 4' ALPI	100	28 lbs.	
-------	----	------------------	-----	---------	--

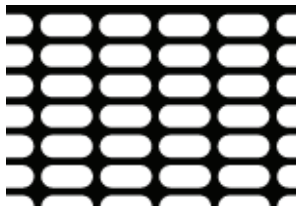

HIGH DENSITY
POLYETHYLENE

4' BARRIER FENCE ROLLS - ORANGE

44517-ORN	4' x 1 1/2" x 2 1/2"	Mesh	100	11 lbs.	
44514-ORN	4' x 3 1/2" x 1 1/2"	Mesh* *BEACON PLUS	100	12.3 lbs.	

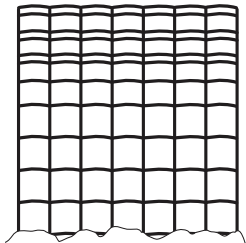

Debris Net

DEBRIS NET ROLLS - HIGH DENSITY POLYETHYLENE

44550-10	4'	Orange	150	17 lbs.	
----------	----	--------	-----	---------	--

- Heavy reinforced selvage edges top & bottom
- Versatile Fabric
- Crowd control
- Other colors available: Red (15) Dark Green (20) Bright Blue (25) Black (30)

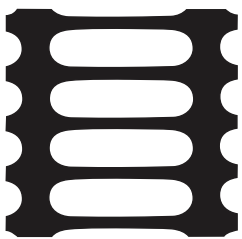

Mesh Size 3" x 1 1/2"

NORDIC — SNOW FENCE

		Nordic Plus II		
44532	4'	Orange - 4'	100	46 lbs.
44532-10	4'	Black - 4'	100	46 lbs.



Mesh Size 1 1/2" x 1 1/2"

SENTRY SECURA — SAFETY FENCE — DIAMOND PATTERN

44260	4'	4' Orange Diamond mesh	50	30 lbs.	
44262	6'	6' Orange Diamond mesh	50	45 lbs.	

- Sentry Secura is also available in 5'

WINDSCREENS FOR

Outdoor Tennis Courts Indoor Tennis Courts Yard Fences
Baseball Fields Overhead Shade Crowd Control Snow Fences

OPEN, CLOSED POLYPROPYLENE WINDSCREEN

Open Mesh

Item# 60600- B (Black) G (Green)
Open Mesh available in 6', 9', 12'; special heights on request:

PRICE

Closed Mesh

Item# 60601- B (Black) G (Green)
Closed Mesh available in 6', 9', 12'; special heights on request:

Characteristics: A light-weight material with less than 1% shrinkage, initial high tensile strength and the greatest abrasive resistance.
Black color has extra long life due to greater ultraviolet resistance and can be used for shade.

POLYETHELENE STANDARD PRIVACY ROLLS

Standard Privacy Rolls — About 90% density with a woven edge.

Item#	Roll Length	Height	PRICE per ROLL
60600-15	150'	5' 8"	
60600-20	150'	7' 8"	

Can be cut on site.

VINYL WINDSCREEN

Item# 60602-
13 - ounce available in 5', 7'6", 10' (5' is seamless).
Color: (B) Black, (G) Green
Characteristics: A solid opaque material giving privacy with sound-reflecting qualities.
A deluxe fabric for indoor or outdoor courts.
13 - ounce available in 6', 8'11", 11'11" (6' is seamless).
Color: Gray, Blue, Brown, Beige, White, Black, Gray (Special heights quoted upon request).

PRICE

STANDARD FEATURES ON WINDSCREEN PRODUCTS

Reinforced hems, brass grommets every foot, no special cutting price for gates, transoms, or short panels.

8530 UNSWORTH AVE. SACRAMENTO, CA 95828-1009 1-916-381-4065	13111 DAHLIA ST. FONTANA, CA 92337-6902 1-909-350-9040	8937 SAN FERNANDO RD. SUN VALLEY, CA 91352-1410 1-818-504-3700	1265 N. CUYAMACA ST. EL CAJON, CA 92020-1549 1-619-449-0333	10010 PORTLAND AVE. TACOMA, WA 98445-3956 1-253-535-5500
---	--	--	---	--

OPTIONAL FEATURES ON WINDSCREEN PRODUCTS

PRICE

Item# 60604-00

Reinforcing tape — A horizontal tape with grommets every foot is recommended for panels over 6' in height. Tape is centered.

Item# 60605-00

Windholes — Vents located in top half of panels every 10' on center.

- (a) Rectangular reinforced holes for polypropylene.
- (b) Circular reinforced holes for solid vinyl and polyester.

Item# 60606-00

Tabs — A flap with grommets sewn on the back of panels.

NETTING

Barrier Netting available in 25' x 100', 25' x 150', 6'6" x 150' and 12'6" x 150' bales.

QUOTED
UPON REQUEST

Item# 60612-10	25' x 100'
60612-15	25' x 150'
60612-05	6'6" x 150'
60612-20	12'6" x 150'

Color: Dark Green

Characteristics: 1" mesh olefin fibers for use at golf courses, baseball fields, etc.

All Purpose Netting available in custom sizes.

Color: Black

Characteristics: Heavy-duty 1 7/8" square nylon weather-treated netting for baseball cages and all other athletic areas.

Bound on all four sides with 1/4" polypropylene black rope.

ATTACHING MATERIALS

#1503 Wire rope for lacing center tape (250' length)

#1504 Polyethylene lacing for perimeter